

Shaft diameter (mm) - Lead (mm)	32 - 5				
Number of circuits / Thread direction	2.5 turns 2 circuits / Right-hand				
Ball diameter (mm)	3.175				
Root diameter (mm)	29.5				
Series	GG	GE			
Basic dynamic load rating C (N)	19000				
Basic static load rating C0 (N)	57200				
Accuracy grade / Axial clearance symbol	C5 / S	C5 / F	C7 / M		
Axial clearance (mm)	0	0.005 or less	0.030 or less		
Preload torque (N·cm)	3.0 to 43.0	Up to 7.0	----		
Spacer ball	None				
Recirculation system	Tube method				
Wiper	Lip seal				
Lubricant	Alvania Grease S2				

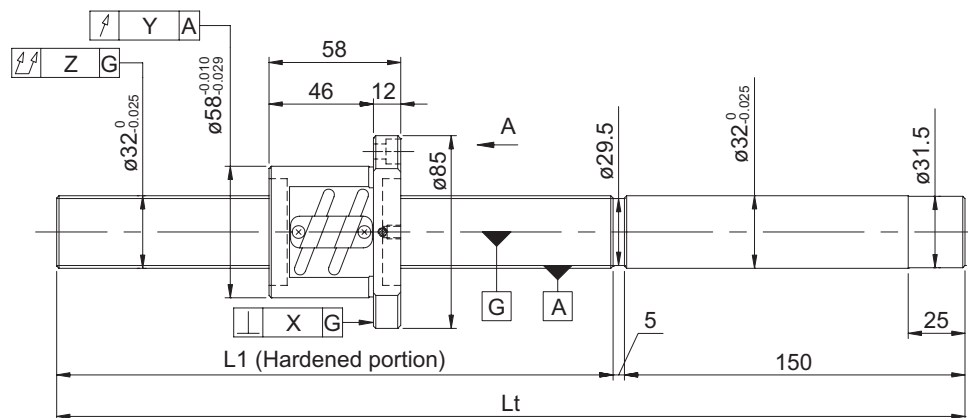
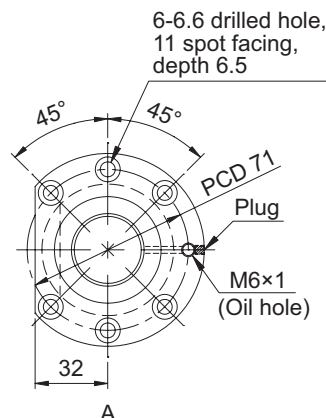

- Product with axial clearance of 0.005 or less (F) shown may be partially preloaded.
- Preload torque is a value before applying grease.

**Screw shaft  
diameter  $\varnothing 32$**

Standard precision ball screws are available with KURODA's recommended shaft end finish types for each size.

Other than KURODA's recommended shaft end finish types described below, additional machining including keyways, tapped holes, and D-cut processing are also available if requested. Please contact KURODA with your orders. Model examples for finished shaft ends are described below.

**Model example:** Unfinished shaft ends (See left figure) → Finished shaft ends  
GG3205ES-DALR-1000A → GG3205ES-DALR-0972X0825-C5F

└─ Thread length  
└─ Overall screw shaft length



- At the time of delivery, grease is inserted inside of the nut, with rust-preventive oil also applied. Before and during use, apply lubricant where appropriate.
- For models with lead accuracy grade of C3 or higher and unfinished shaft ends, consult KURODA.